

Quadro de Cargas e Distribuição					
CIRCUITO	LAMPADAS	RODASIAS	Potência (condução protegido) (P) (mm²)	Área (A)	FINALIDADE
1	40w	100w	100w	1,5	ILUMINAÇÃO/RODASIAS
2	-	-	3400	4,0	CHUVEIRO
TOTAL	-	-	4100	6,5	ALUMINADOR

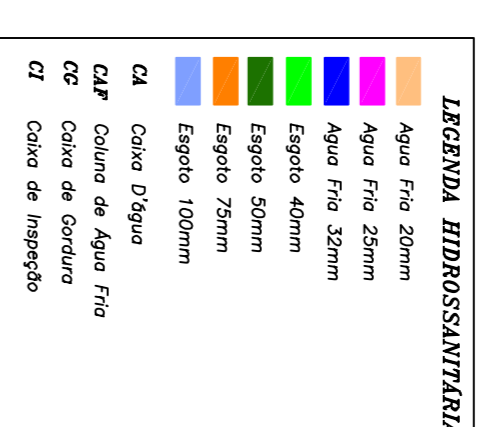
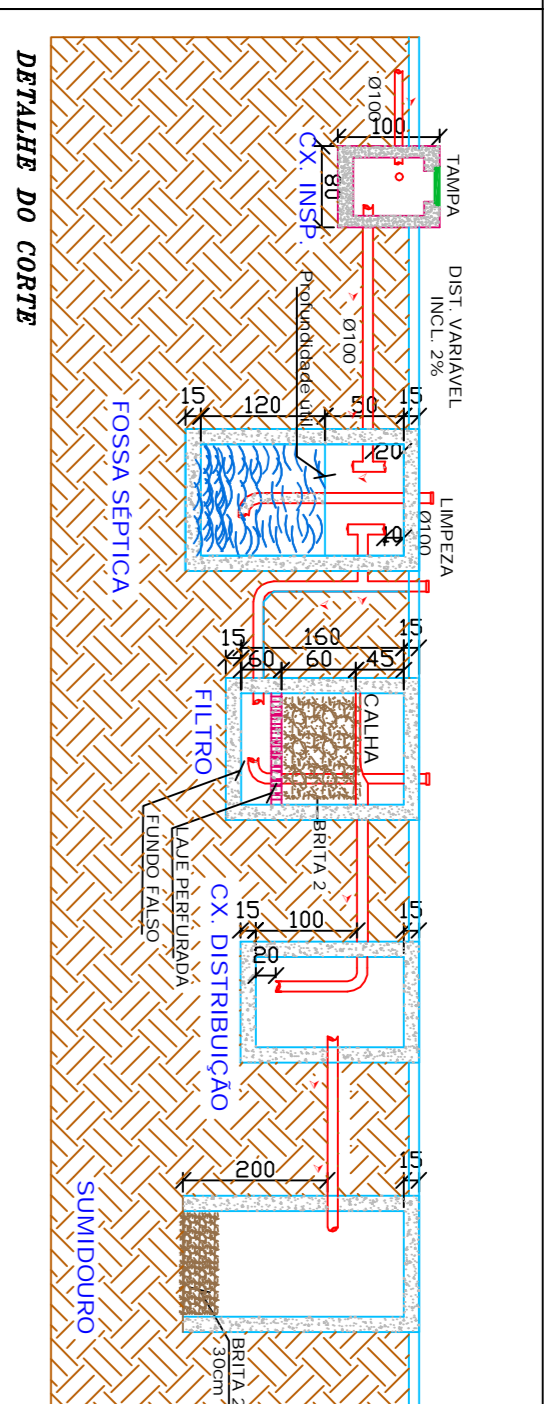
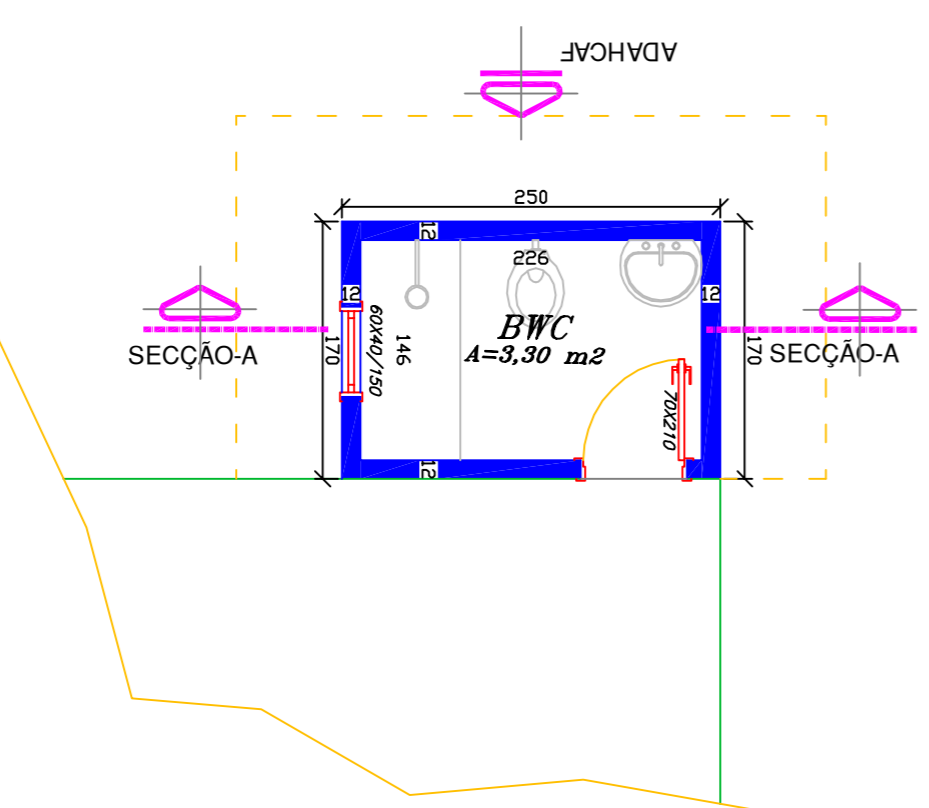
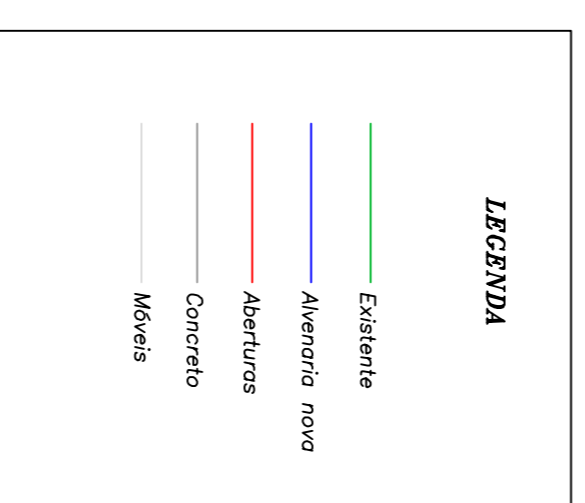
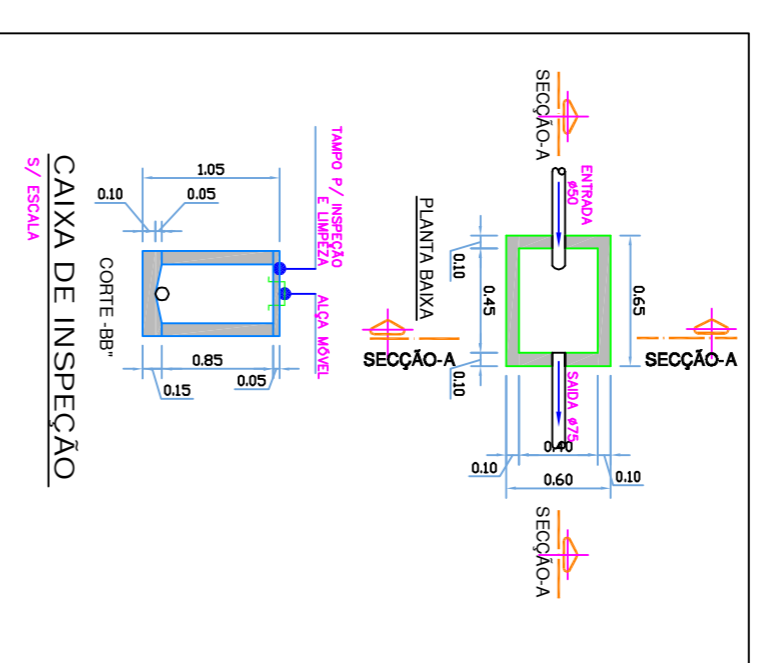
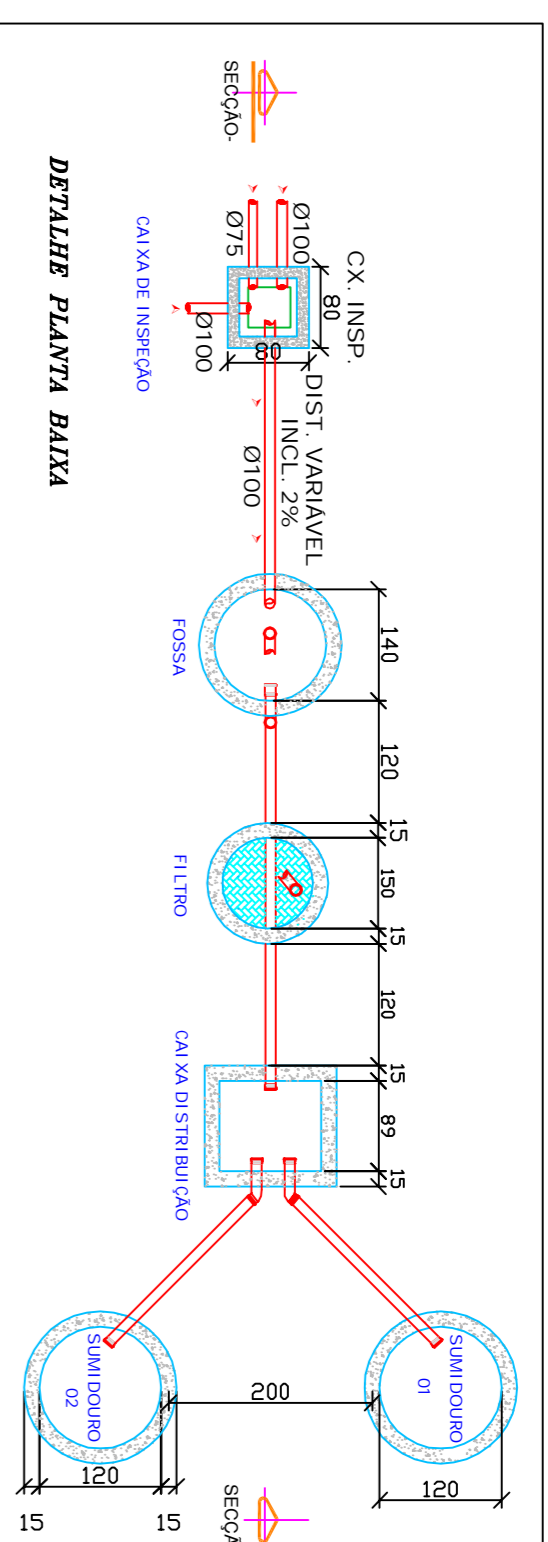
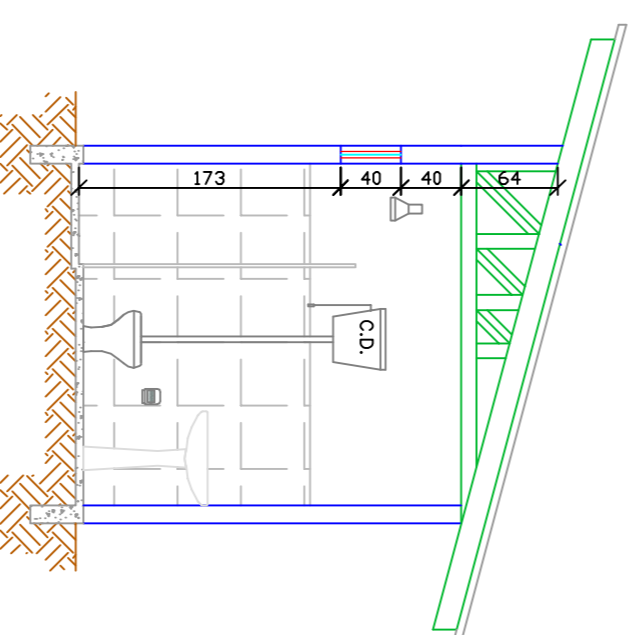
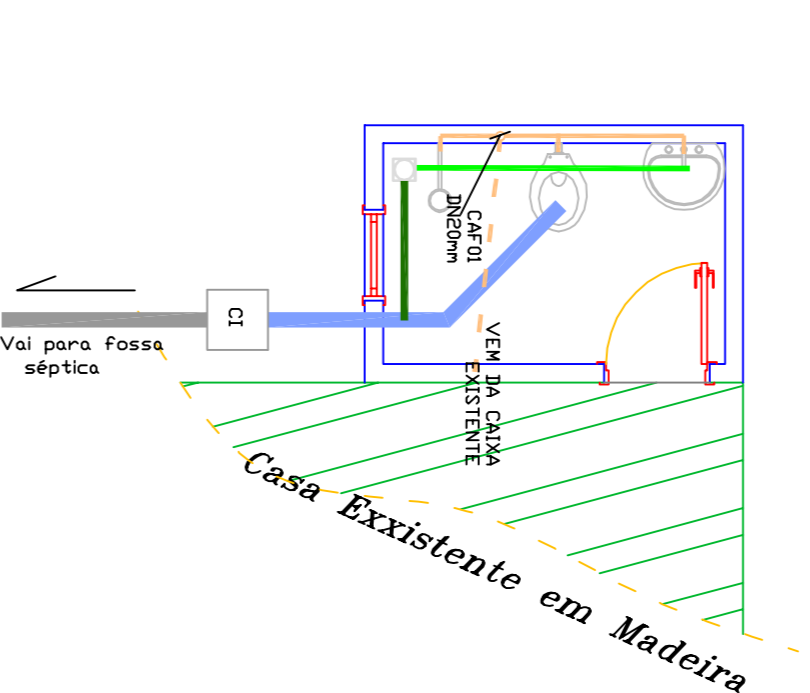
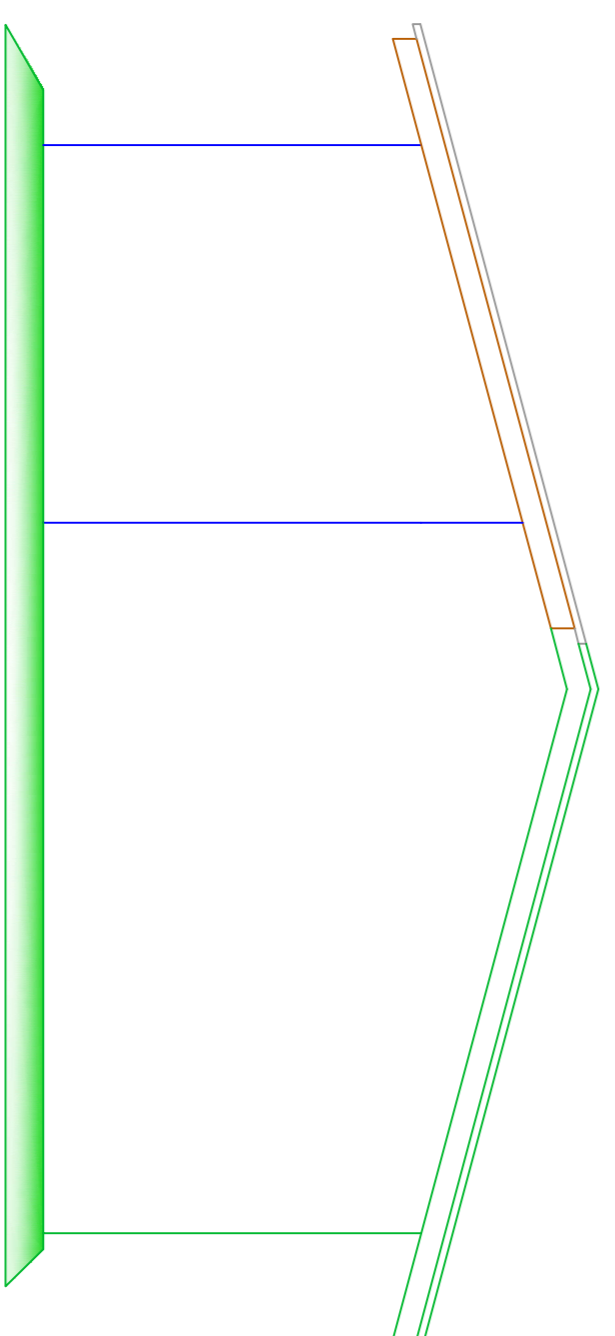
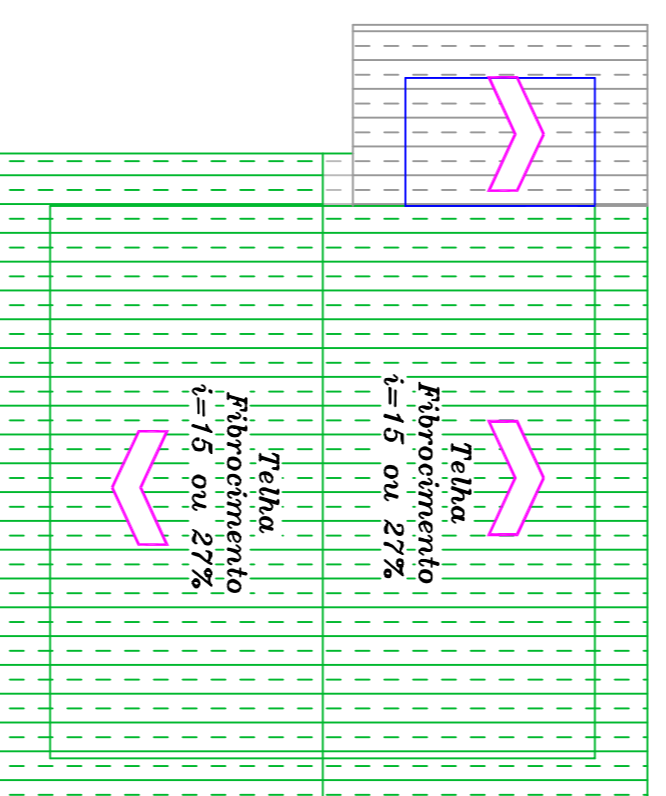
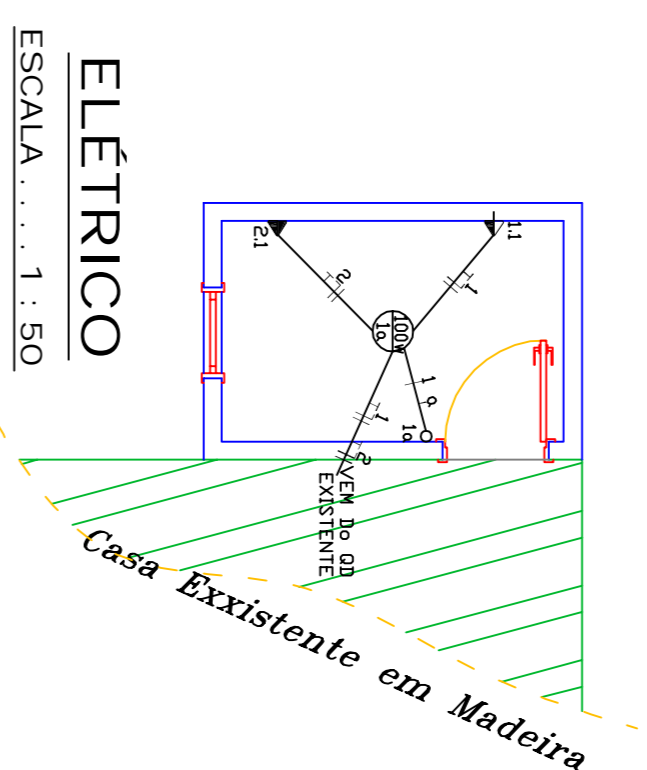

**AMPLASC**

ASSOCIAÇÃO DOS MUNICÍPIOS DO  
PLANALTO SUL DE STA. CATARINA

Município: **Celso Ramos - SC.**

Projeto: **Construção de Sanitário para Unidade Residencial**

Proprietário: **Diversos**

Título: **ARQUITETÔNICO E COMPLEMENTARES**

DATA	DESCRIÇÃO	ÁREA CONSTRUIDA	ÁREA TOTAL
Julho/2014	<b>Muros Regulares/Ladrillaria</b>	4,25m²	
ESCALA: DCE 1:50	CONDIÇÃO	PROPOSTA	
ESCALA: ANTERIOR	BMC/Residenciais	<b>01-01</b>	